



## Frome Square, Hemel Hempstead, HP2 6EH

### **£415,000**

Clements Estate Agents are delighted to offer this stunning and spacious FOUR bedroom End of Terrace family home. Boasting a modern fitted kitchen/diner, bathroom and shower room. Other benefits include spacious room sizes, large out building, off street parking, well kept gardens and a convenient Cul de sac location and is offered with NO UPPER CHAIN. Call now to view!

**Entrance Hall**

Double glazed door and window, wood flooring, storage cupboard, radiator and stairs to first floor.

**Living Room 14'08 x 11'05 (4.47m x 3.48m )**

Open plan to kitchen/diner, double glazed window, radiator and coving.

**Kitchen/Diner 20'04x 17'08 (6.20mx 5.38m)**

Modern fitted kitchen with wall and base units and work surfaces to compliment. island unit with base units, sink with mixer taps and drainer and integrated dishwasher, sky light, gas hob with cooker hood over, double electric oven, cupboard with plumbing for washing machine, wood flooring and double glazed french doors to garden.

**Shower Room**

Double glazed window, shower cubicle, wash hand basin with vanity unit, low level wc, extractor fan, tiled floors and walls.

**Bedroom Four 10'05 x 11'07 (3.18m x 3.53m )**

Two double glazed windows, coving and radiator.

**Landing**

Double glazed window, loft access and airing cupboard.

**Bedroom One 12'04 x 11'02 (3.76m x 3.40m)**

Double glazed window and radiator.

**Bedroom Two 12'05 plus door recess x 9'06 (3.78m plus door recess x 2.90m)**

Double glazed window and radiator.

**Bedroom Three 9'05 x 6'04 (2.87m x 1.93m)**

Double glazed window and radiator.

**Bathroom**

Double glazed window, bath with shower over, low level wc, wash hand basin with vanity unit, heated towel rail, part tiled walls and tiled floor.

**Front**

Paved off road parking.

**Rear Garden**

Side access, paved area and artificial grassed.

**Brick Built Outbuilding**

Double glazed patio doors and able to be used as either an office or gym.

Floor Plan

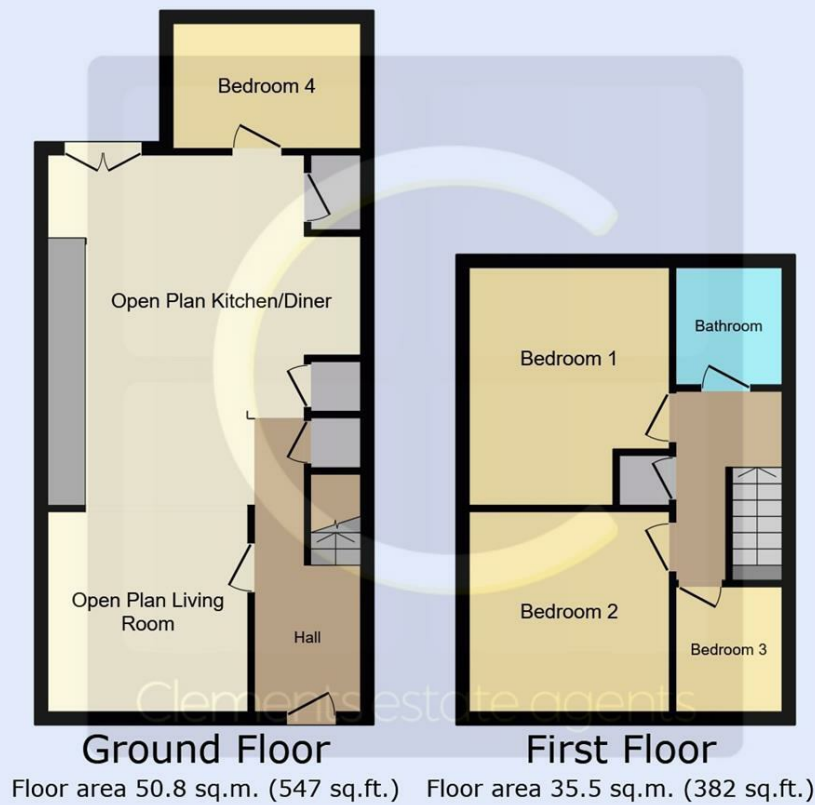

This floor plan is for illustrative purposes only. It is not drawn to scale. Any measurements, floor areas (including any total floor area), openings and orientations are approximate. No details are guaranteed, they cannot be relied upon for any purpose and do not form any part of any agreement. No liability is taken for any error, omission or misstatement. A party must rely upon its own inspection(s). Powered by [www.Propertybox.io](http://www.Propertybox.io)



Area Map

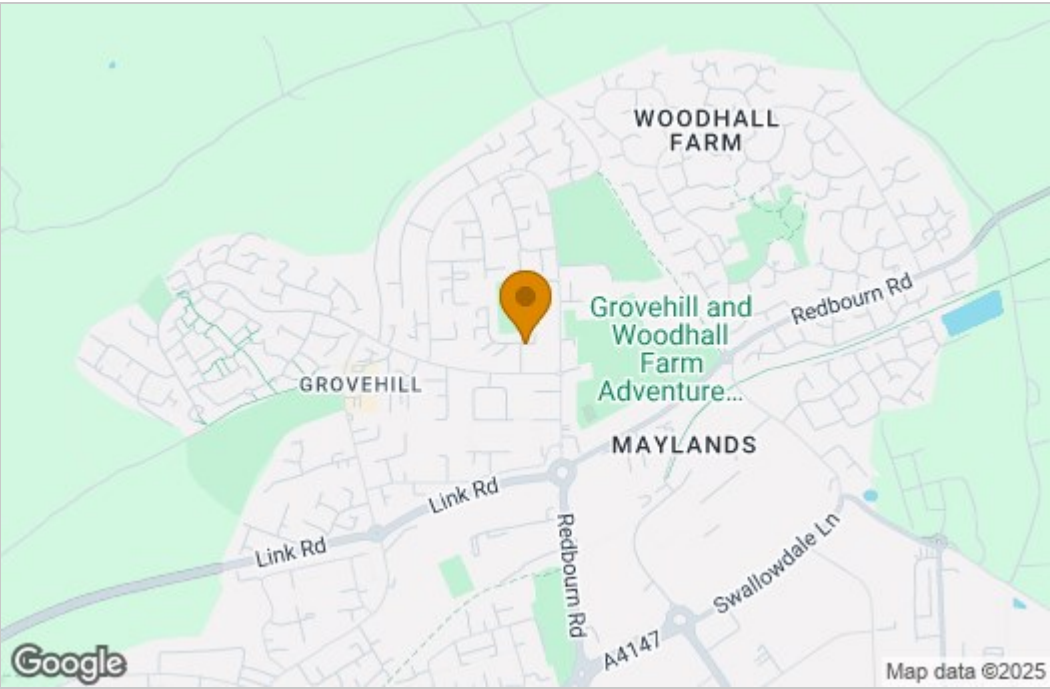

Energy Efficiency Graph

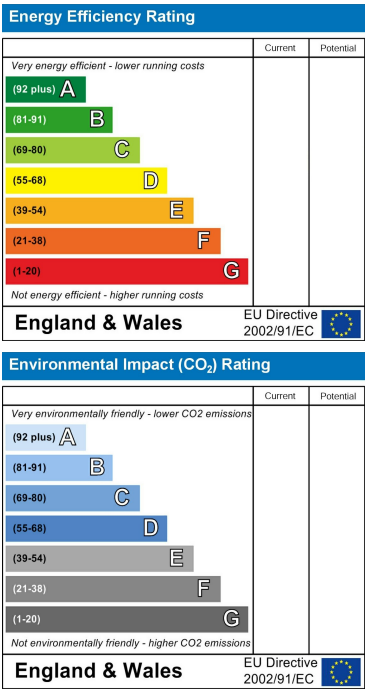

These particulars, whilst believed to be accurate are set out as a general outline only for guidance and do not constitute any part of an offer or contract. Intending purchasers should not rely on them as statements of representation of fact, but must satisfy themselves by inspection or otherwise as to their accuracy. No person in this firm's employment has the authority to make or give any representation or warranty in respect of the property.